

1 2 3 4 5 6 7 8

DMG.No. BAMS-0954

SIZE	PIPE THREADS	P	L	H	W	D	S	Q, TY
	d							
1/4	Rc 1/4	8	55	45	60	27	18	

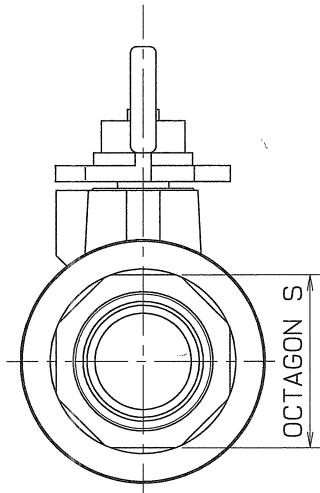
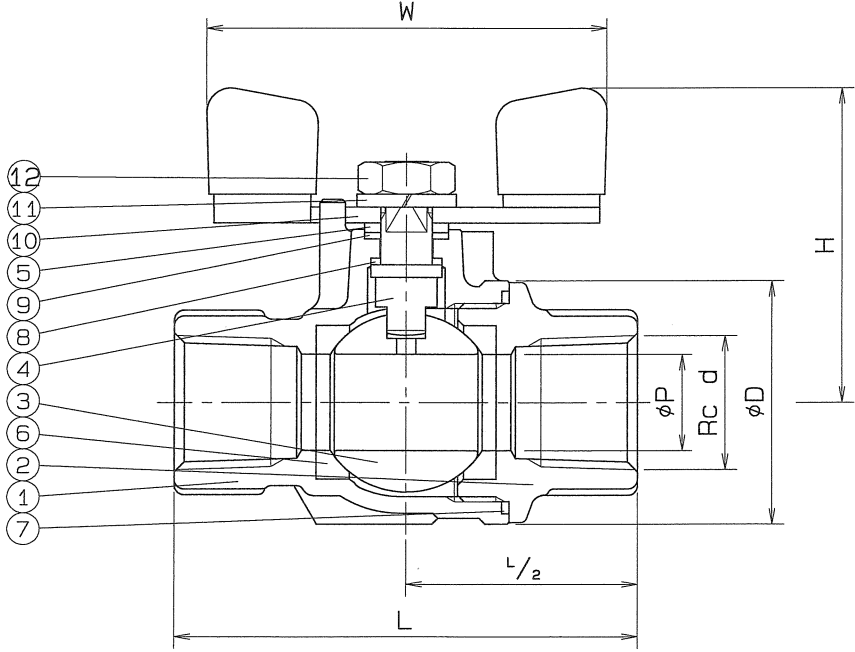
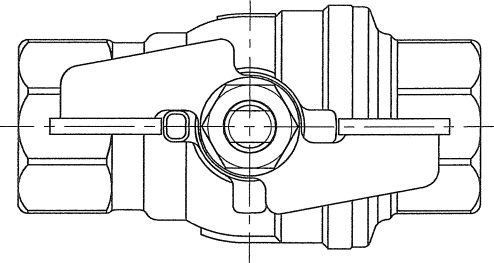

SPEC.		TEST PRESS.	
FLUID		SHELL	HYDRO 8.24 MPa (84 kgf/cm ²)
PRESS.	MPa (kgf/cm ²)	SEAT	AIR 0.6 MPa (6.1 kgf/cm ²)
TEMP.	°C	AIR	MPa (kgf/cm ²)

PIPE THREADS CONFORM WITH 'JIS B 0203'

No.	NAME OF PARTS	Q.TY	MATERIALS	REMARKS
12	HEXAGON NUT	1	SUS 304	
11	SPRING WASHER	1	SUS 304	
10	HANDLE	1	SUS 304	
9	THRUST BEARING	1	P.T.F.E.	CARBON FILLED
8	THRUST PACKING	1	P.T.F.E.	CARBON FILLED
7	GASKET PACKING	1	P.T.F.E.	
6	BALL SEAT	2	SUS 304	
5	GLAND	1	SUS 304	
4	STEM	1	SUS 304	
3	BALL DISC	1	SUS 304	
2	BODY CAP	1	SCS 13	
1	BODY	1	SCS 13	

NAME	800 W.O.G. SCREWED ENDS MINI BALL VALVES FULL BORE		
TYPE	N-620A	SIZE	1/4 B
DMG.No.	BAMS-0954	APPROVED BY	K. Juneto
DATE	JUL. 25. 2008.	CHECKED BY	H. Akida
SCALE	:	DESIGNED BY	
THIRD ANGLE PROJECTION METHOD		DRAWN BY K. Taketaka	

O. N. INDUSTRIES LTD.

付込表のスケール変更・3/8~3/4B削除 H20. 9. 18.