

◇ Dwg. No. BAMS-0947

SIZE	PIPE THREADS	P	L	H	W	D	Q, TY
	d						
1 1/2	Rc 1 1/2	32	100	96	170	67	
2	Rc 2	40	120	102	170	80	

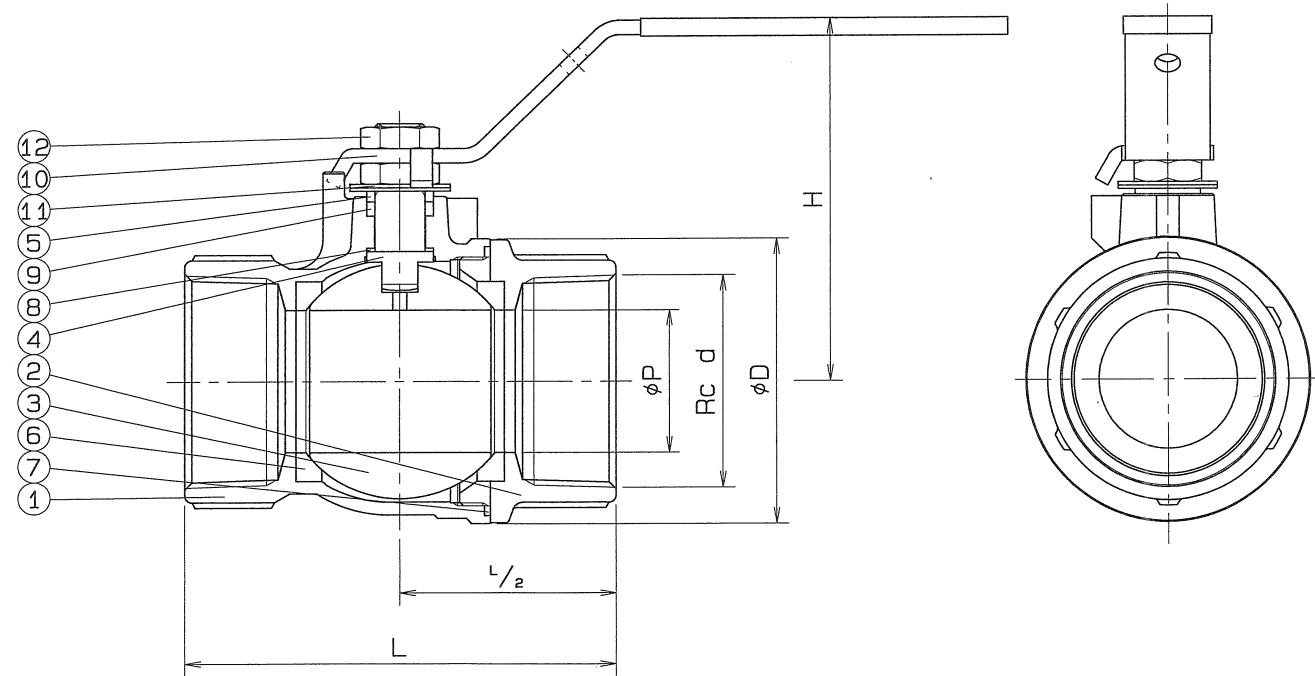
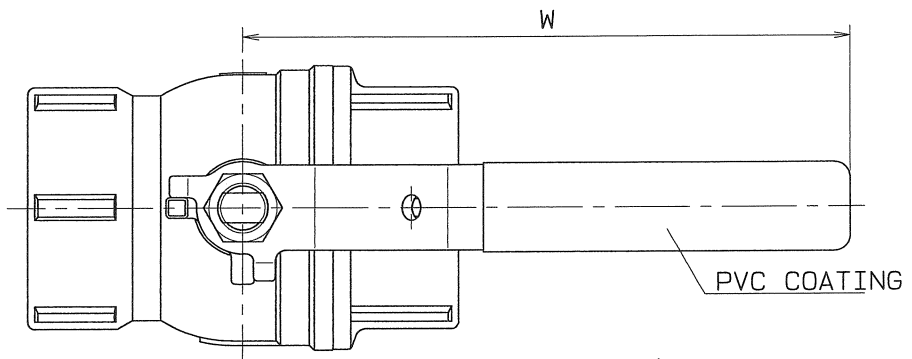

SPEC.		TEST PRESS.	
FLUID		SHELL	HYORO 8.24 MPa (84 kgf/cm <sup>2</sup> )
PRESS.	MPa (kgf/cm <sup>2</sup> )	SEAT	AIR 0.6 MPa (6.1 kgf/cm <sup>2</sup> )
TEMP.	°C	AIR	MPa (kgf/cm <sup>2</sup> )

PIPE THREADS CONFORM WITH 'JIS B 0203'

No.	NAME OF PARTS	Q. TY	MATERIALS	REMARKS
12	HEXAGON NUT	2	SUS 304	
11	CONICAL WASHER	2	SUS 304	
10	HANDLE	1	SUS 304	
9	GLAND PACKING	1	P.T.F.E.	
8	THRUST PACKING	1	P.T.F.E.	CARBON FILLED
7	GASKET PACKING	1	P.T.F.E.	
6	BALL SEAT	2	P.T.F.E.	
5	GLAND	1	SUS 304	
4	STEM	1	SUS 304	
3	BALL DISC	1	SCS 13A	
2	BODY CAP	1	SCS 13	
1	BODY	1	SCS 13	

NAME	800 W.O.G. SCREWED ENDS MINI BALL VALVES REGULAR BORE		
TYPE	N-610A	SIZE	1 1/2, 2 B
DWG. No.	BAMS-0947	APPROVED BY	<i>A. Tamoto</i>
DATE	APR. 4. 2008	CHECKED BY	<i>A. Adachi</i>
SCALE	:	DESIGNED BY	<i>K. Takahashi</i>

THIRD ANGLE PROJECTION METHOD DRAWN BY *K. Takahashi*

**O. N. INDUSTRIES LTD.**

寸法表のスケール変更 H20. 9. 18.