

DWG No. BAMS-0915

| SIZE | PIPE THREADS d | P | L | H | W | D | S | F | Q, TY |
|-------|-------------------|----|-----|-----|-----|-----|----|-----|-------|
| 2 1/2 | Rc 2 1/2 | 50 | 145 | 131 | 230 | 98 | 85 | 5.1 | |
| 3 | Rc 3 | 65 | 170 | 141 | 230 | 119 | 99 | 5.1 | |

A
B
C
D
E
F

A
B
C
D
E
F

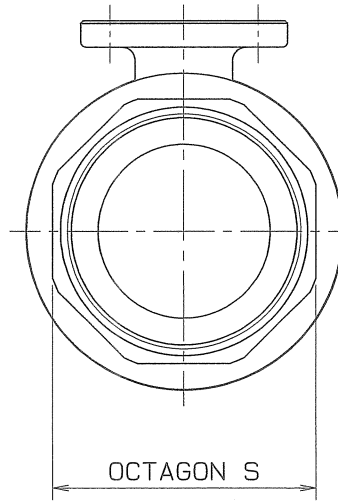
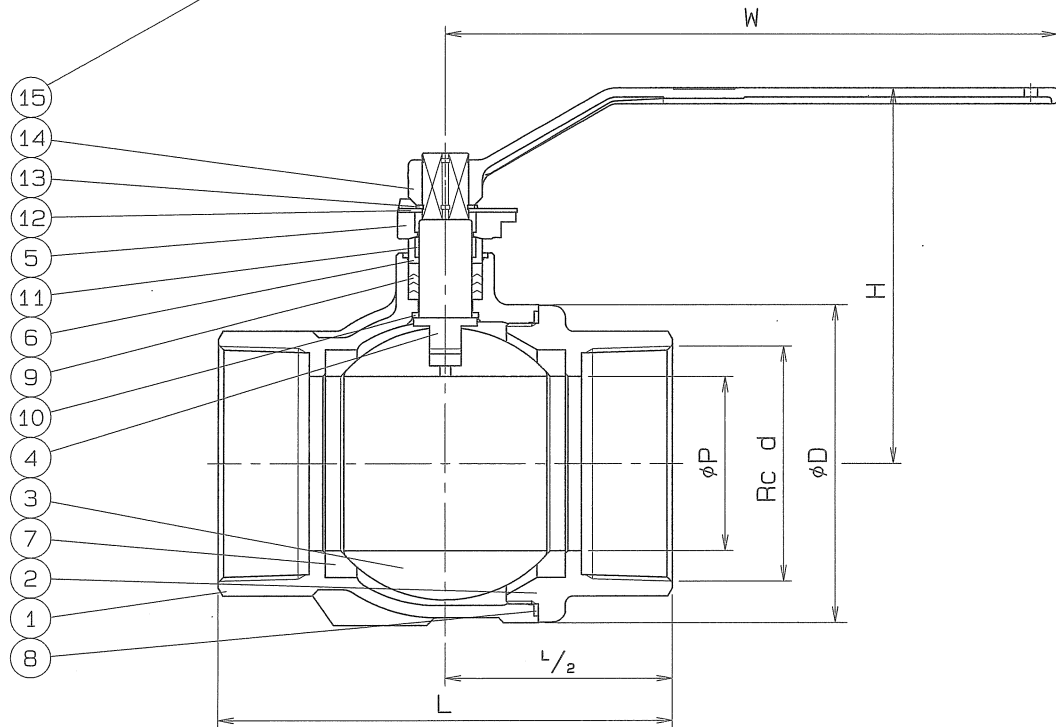
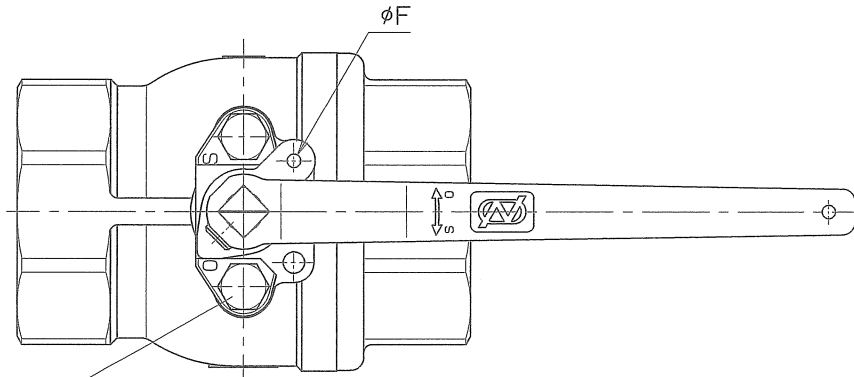

| SPEC. | | TEST PRESS. | |
|--------|--------------------------------|-------------|--|
| FLUID | | SHELL | HYDRO 2.1 MPa (21.4 kgf/cm ²) |
| PRESS. | MPa (kgf/cm ²) | SEAT | ATR 0.6 MPa (6.1 kgf/cm ²) |
| TEMP. | °C | ATR | MPa (kgf/cm ²) |

PIPE THREADS CONFORM WITH "JIS B 0203"

| No. | NAME OF PARTS | Q.TY | MATERIALS | REMARKS |
|-----|----------------|------|-----------|--------------|
| 15 | GLAND BOLT | 2 | SUS 304 | |
| 14 | HANDLE | 1 | SCS 13 | |
| 13 | STOP RING | 1 | SUS 304 | |
| 12 | STOPPER | 1 | SUS 304 | |
| 11 | STEM BEARING | 1 | P.T.F.E. | GLASS FILLED |
| 10 | THRUST BEARING | 1 | P.T.F.E. | GLASS FILLED |
| 9 | GLAND PACKING | 1SET | P.T.F.E. | |
| 8 | GASKET PACKING | 1 | P.T.F.E. | |
| 7 | BALL SEAT | 2 | P.T.F.E. | |
| 6 | GLAND SLEEVE | 1 | SUS 316 | |
| 5 | GLAND | 1 | SCS 13 | |
| 4 | STEM | 1 | SUS 304 | |
| 3 | BALL DISC | 1 | SCS 13A | |
| 2 | BODY CAP | 1 | SCS 13A | |
| 1 | BODY | 1 | SCS 13A | |

| | | | | |
|-------------------------------|--|-------------|--------------------|--|
| NAME | 400 W.O.G. SCREWED ENDS MINI BALL VALVES REGULAR BORE | | | |
| TYPE | N-610 | SIZE | 2 1/2, 3 B | |
| DWG.No. | BAMS-0915 | APPROVED BY | <i>S. Suneta</i> | |
| DATE | APR. 12. 2007 | CHECKED BY | <i>M. Adhikari</i> | |
| SCALE | : | DESIGNED BY | - | |
| THIRD ANGLE PROJECTION METHOD | | DRAWN BY | <i>K. Subbaraj</i> | |

O. N. INDUSTRIES LTD.

| | | |
|---|--|--|
| △ | | |
| △ | | |
| △ | | |