

◇ 8870-SWAB \*OMG

SIZE	P	L <sub>1</sub>	L <sub>2</sub>	H <sub>1</sub>	H <sub>2</sub>	W	D	Q, TY
13 Su	15	83	75	91	45	100	38	
20 Su	20	95	85	101	46	130	46.5	
25 Su	25	99	87	104	46	130	54	

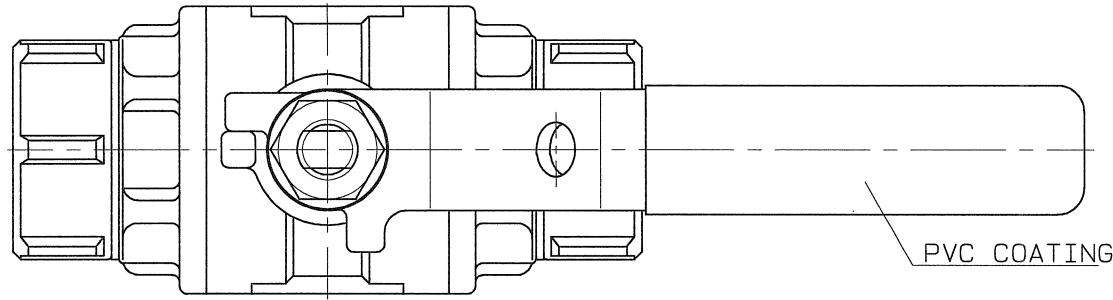

PVC COATING

SPEC.		TEST PRESS.	
FLUID		SHELL	HYDRO 3.5 MPa (35.7 kgf/cm <sup>2</sup> )
△△ PRESS.	MAX 2.0 MPa (20.4 kgf/cm <sup>2</sup> )	SEAT	AIR 0.6 MPa (6.1 kgf/cm <sup>2</sup> )
△△ TEMP.	MAX 100°C		AIR ( MPa kgf/cm <sup>2</sup> )

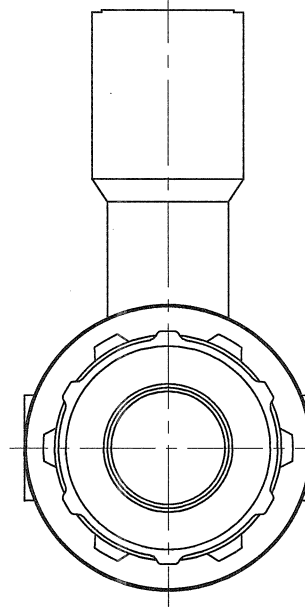
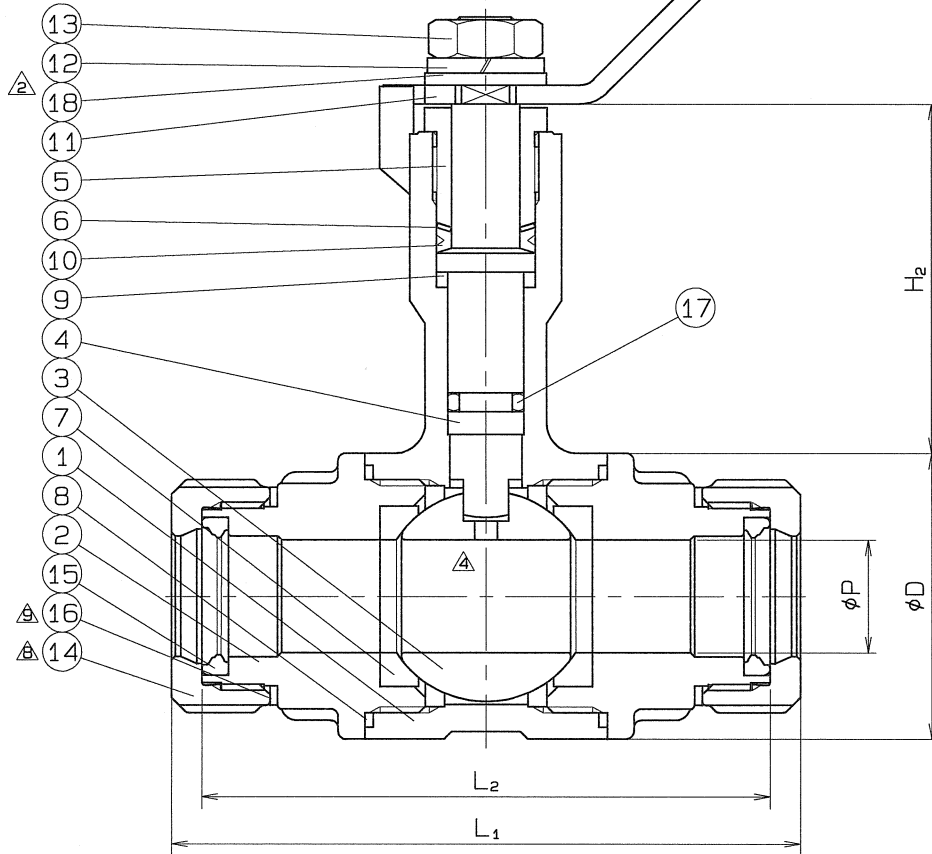

△\*SPECIAL TEFLON

18	PLAIN WASHER	1	SUS 304	
17	O RING	1	VITON	
△△ 16	CONICAL WASHER	2	JFE443CT	
15	RUBBER PACKIG	2	SYNTHETIC RUBBER (HNBR)	
△ 14	NUT	2	SCS 13	
13	HEXAGON NUT	1	SUS 304	
12	SPRING WASHER	1	SUS 304	
11	HANDLE	1	SUS 304	
10	GLAND PACKING	1	P.T.F.E.	
9	BEARING	1	P.T.F.E.	CARBON FILLED
8	GASKET PACKING	2	P.T.F.E.	
△ 7	BALL SEAT	2	P.T.F.E.	*
6	WASHER	1	SUS 304CSP	
△ 5	GLAND BUSHING	1	SCS 13	
4	STEM	1	SUS 304	
△ 3	BALL DISC	1	SCS 13A	△
2	BODY CAP	2	SCS 13	
1	BODY	1	SCS 13	

No.	NAME OF PARTS	Q.TY	MATERIALS	REMARKS
NAME NICE JOINT ENDS FULL BORE LONG NECK TYPE MINI BALL VALVES				
TYPE NJ-220		SIZE	13~25Su	
DWG.No.	BAMS-0788 ◇	APPROVED BY	<i>H. Sakai</i>	
DATE	MAY. 26. 1997	CHECKED BY	<i>H. Sakai</i>	
SCALE	:	DESIGNED BY	-	
THIRD ANGLE PROJECTION METHOD		DRAWN BY	<i>H. Sakai</i>	

△ 使用圧力, 使用温度追加	H24. 1. 13.
△ 検査圧力の変更	H23. 2. 9.
△ 皿ワッシャ材質変更	H22. 2. 10.

**O. N. INDUSTRIES LTD.**